



BRITAL

ALUMINIUM SYSTEMS DESIGN

/ Minimal Folding System



brital.ae



Founded in the United Kingdom, Brital brings over 25 years of expertise in comprehensive aluminium systems — from façades to doors and windows. With a strong presence in Dubai and across the globe, our systems combine British quality with global adaptability to meet diverse project requirements



Minimal Folding

The Brital Minimal Folding System TB50 is a high-performance aluminium folding door solution designed for minimal sightlines, excellent thermal insulation, and smooth, reliable operation. This system is suitable for modern architectural applications requiring large opening areas, slim aesthetics, and enhanced energy efficiency.

Why Choose the **TB50** Minimal Folding

DESIGN • FLEXIBILITY • PERFORMANCE



Minimal sightlines

Clean, modern profiles with a minimalistic look.



Wide opening capacity

Multiple folding panels for large clear openings.



High panel dimensions

Up to 3500 mm height and 1200 mm width.



Smooth & effortless operation

High-quality hardware ensures smooth folding action.



Thermal break profiles

Improved comfort and enhanced energy efficiency.



Flexible threshold options

Standard or low threshold (14 mm) for accessibility.



Architect-preferred design

deal for modern façades and indoor-outdoor living.

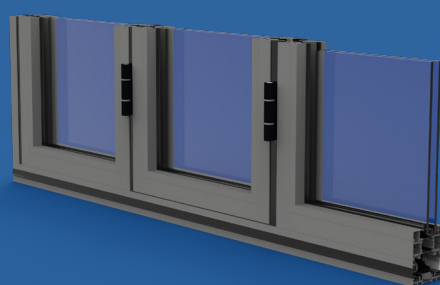

Technical Specifications

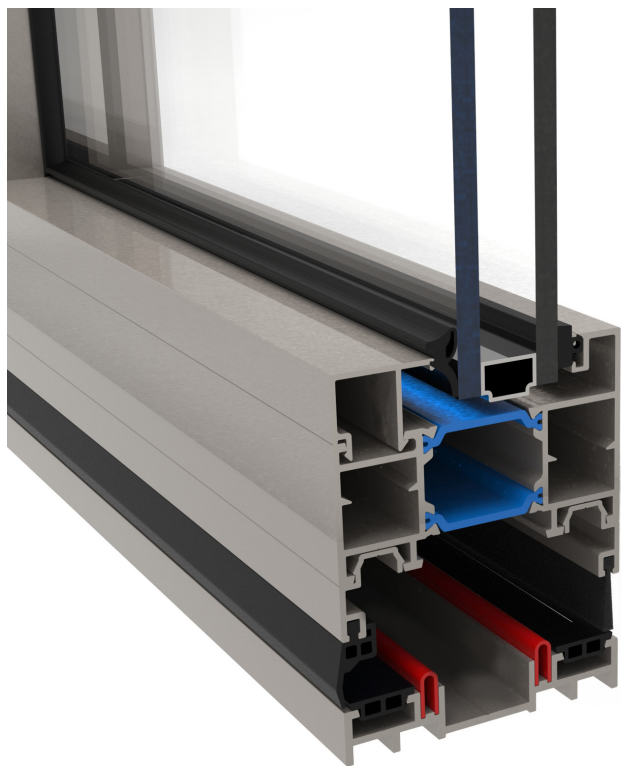

Presentation of the Series

Thermal break (TB): Yes 24/32mm
Main frame: 46.5 mm
Main sash: 50 mm
Overall profile thickness: 1.6 mm
Maximum glazing: 52 mm
Maximum sash weight: 120 kg
Maximum panel Height: 3500 mm
Maximum panel Width: 1200 mm
Low threshold: 14 mm
Standard threshold: 46.5 mm

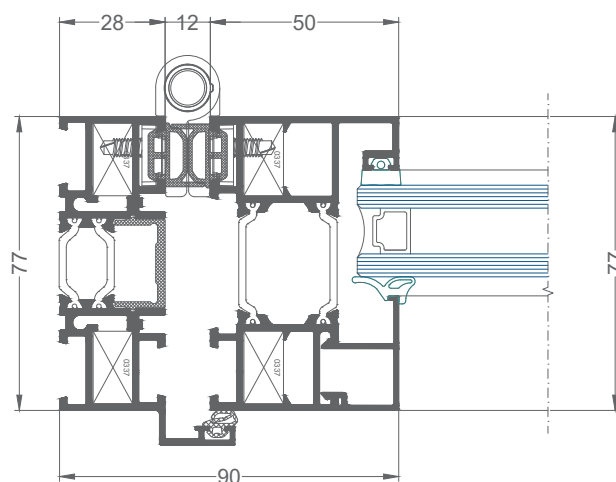

■ Embedded bottom track

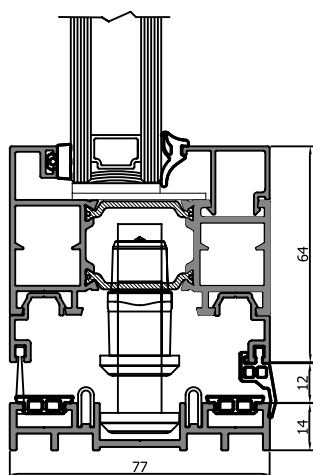

Bottom track 14 mm

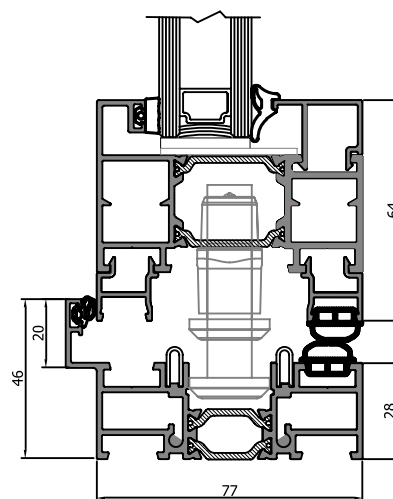

Bottom track 28 mm



Transform your
view, expand
your living

Unlimited **opening** & folding combinations





■ Folding Opening Direction

Outward Opening

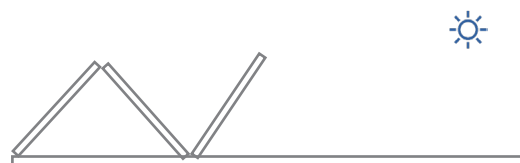

Inward Opening



■ Folding System

Panels Stacked on One Side

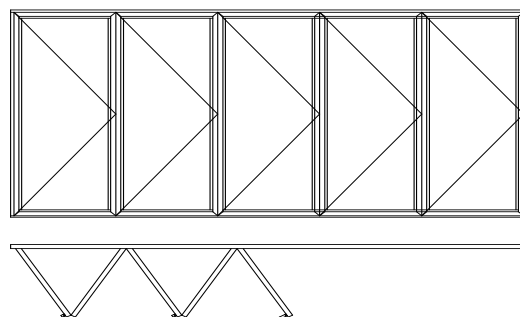

Panels Stacked on Both Sides

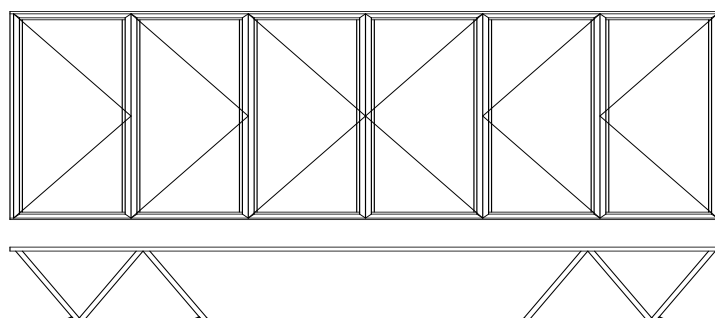

Panel Dimensions

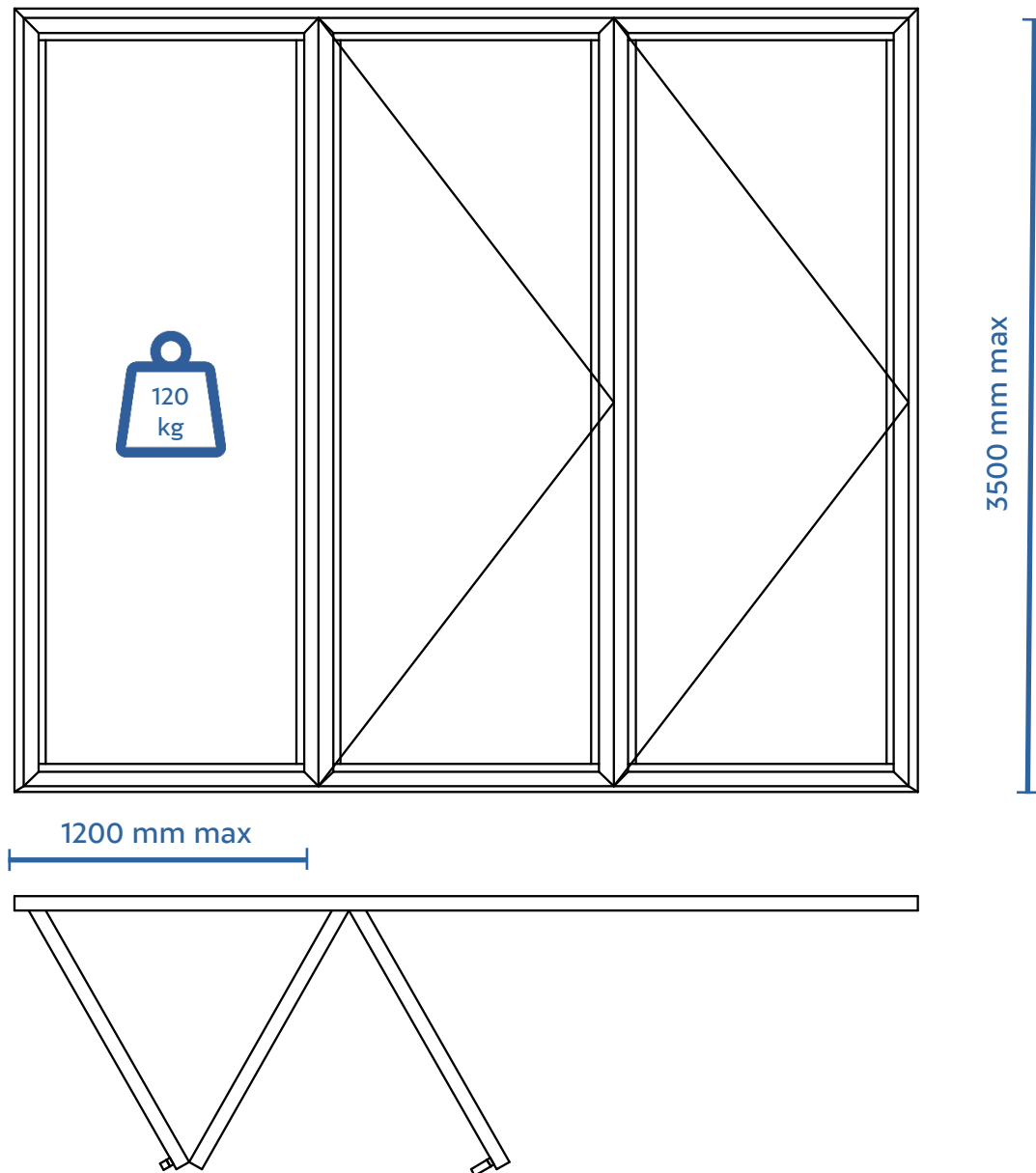

The system's panels are engineered to reach up to 1200 mm wide and 3500 mm high, offering large, elegant openings .

Each panel supports up to 120 kg.

With glazing capacity up to 52 mm, the folding system supports both double and triple glass units, ensuring superior thermal and sound insulation.

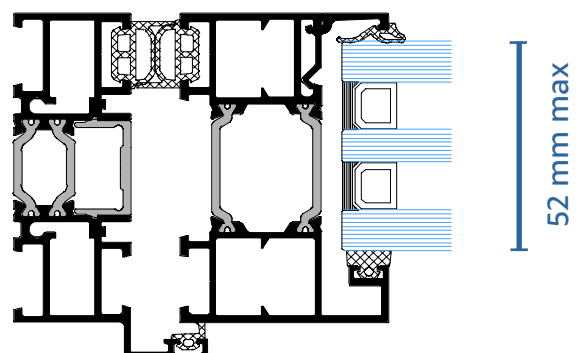

Typology of Folding systems

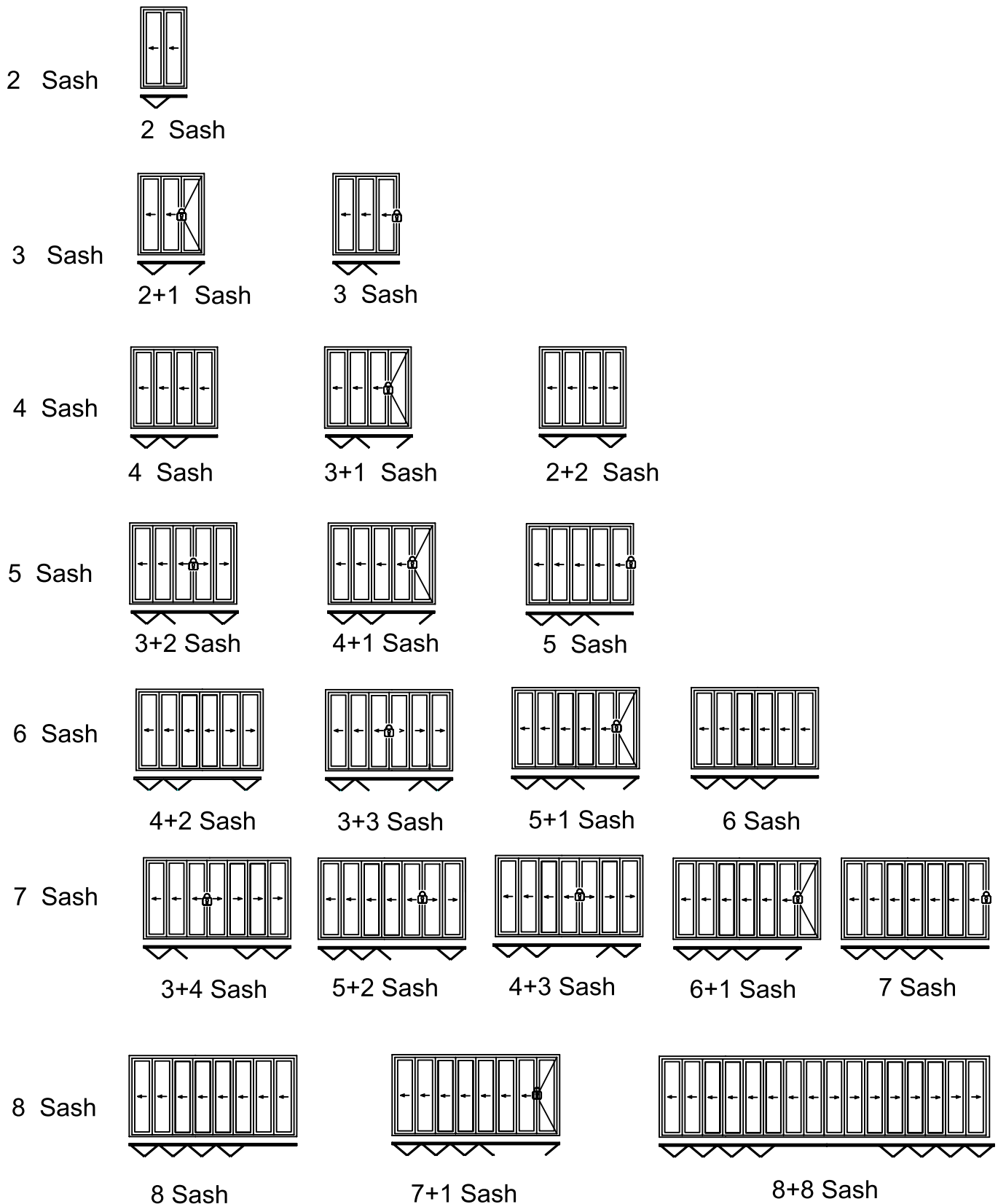

Corner Solution

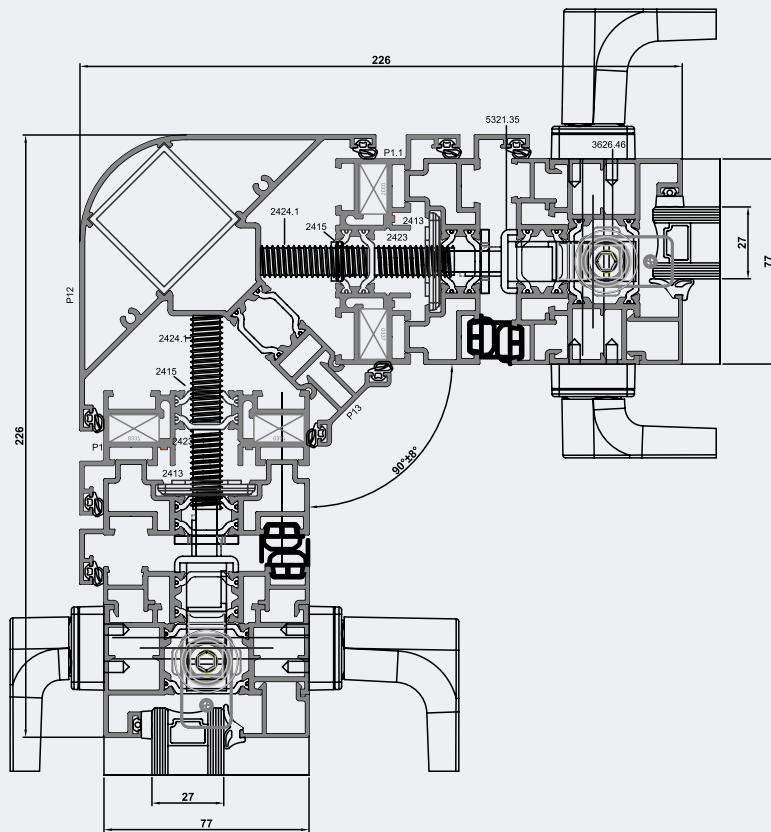

Section - Curved Corner Solution

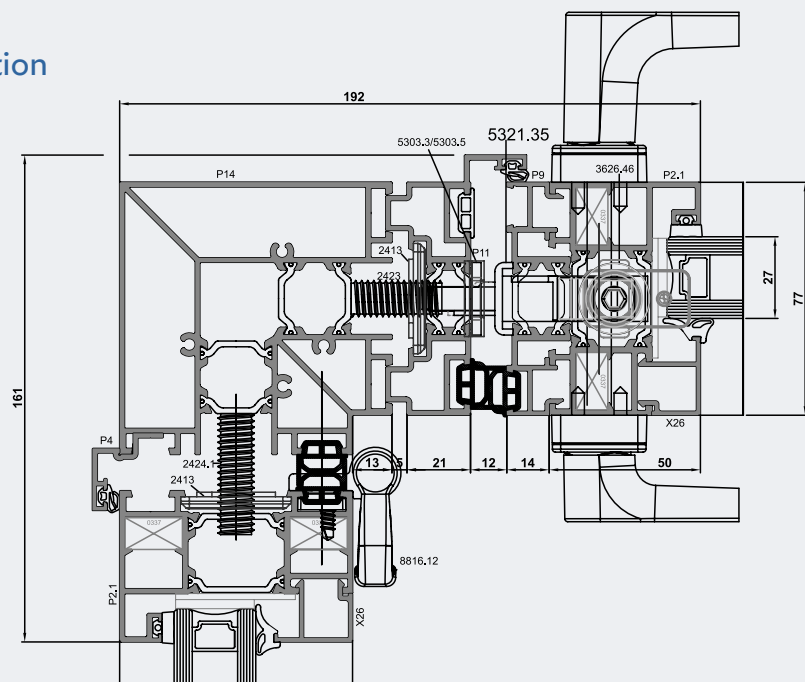
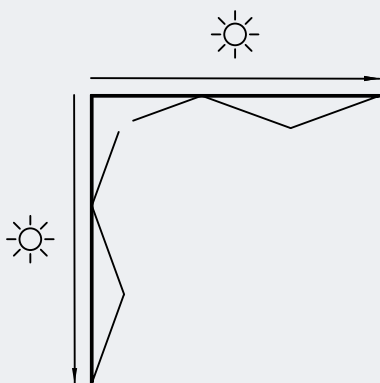

Section - Straight Edge Solution

Flexibility of fittings

Master Italy accessories.



Two-side handle
- KARMA
[Art. 3067](#)



Double reduced handle
- KARMA
[Art. 3068](#)



Two-side handle
- ITALIA
[Art. 3065](#)



Reduced handle
- KARMA
[Art. 3106](#)



Handle
- KARMA
[Art. 3100](#)

Operating Hardware

Flexibility of fittings

Master Italy accessories.



Art. 8816.14
Pulling hinge
(external opening)



Art. 8815.12
Hinge with
inserting plate



Art. 8810.11
Lower roller

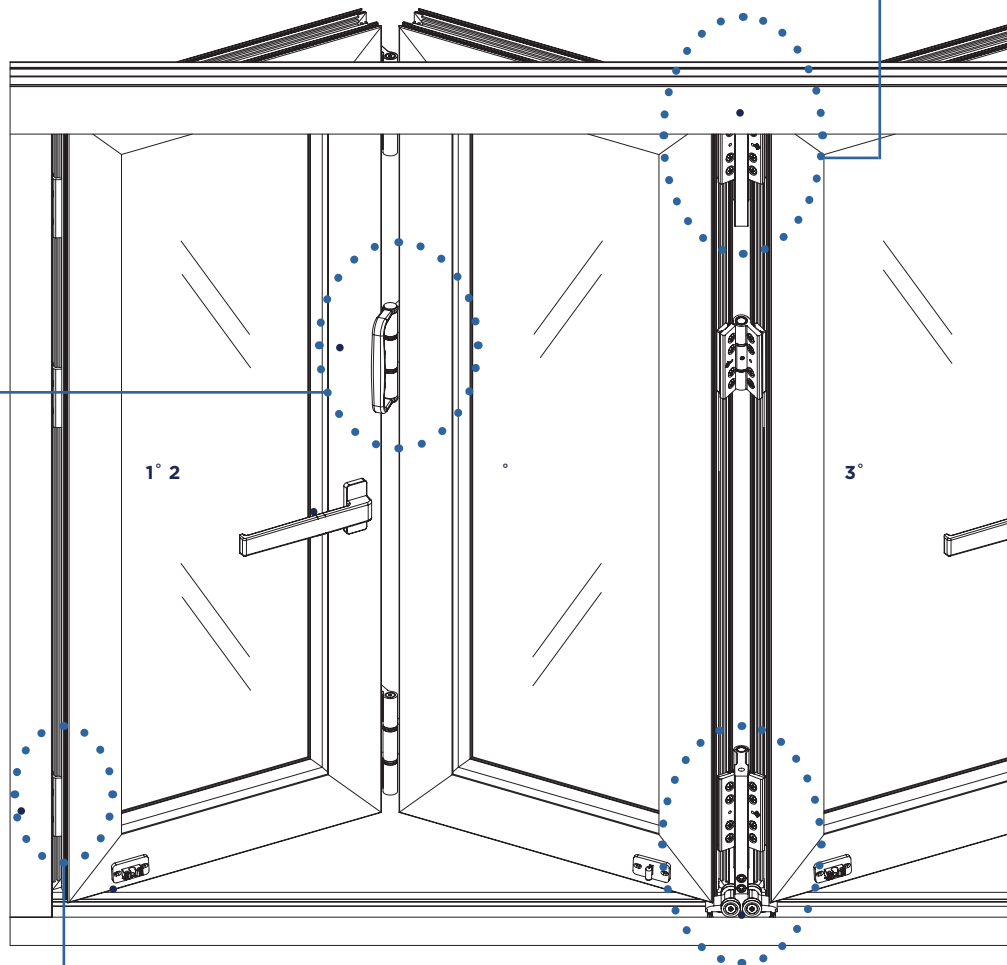



Art. 8810.10
Upper roller



Art. 8811.10
Lower roller for
even sash

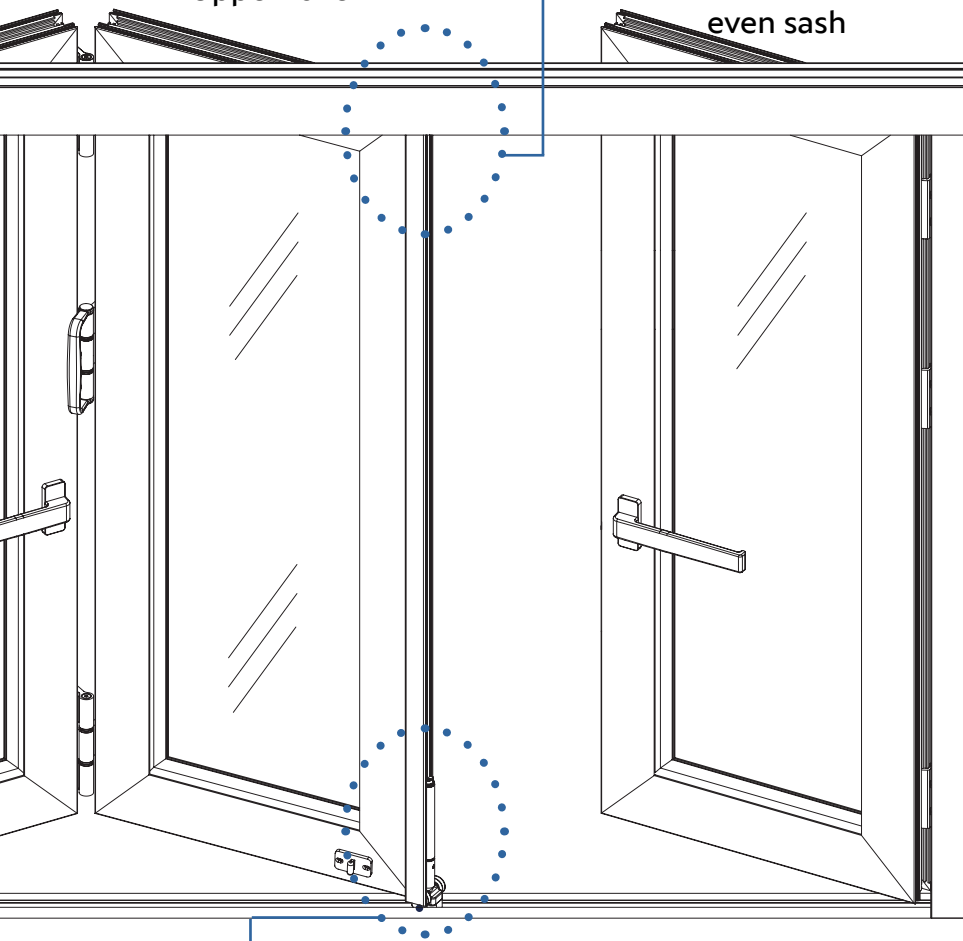

Art. 8811.11
Upper roller for
even sash

Design :

- Modern and versatile folding system.
- Works with standard, embedded, or lowered thresholds.

Performance :

- Up to 8 sashes, 120 kg per sash.
- Maximum dimensions: 3500 mm height × 1200 mm width
- Hinges and rollers distribute weight on the lower track for smooth operation.

Flexibility

- Thermal break solutions for maximum comfort
- Suitable for folding or sliding configurations.

Safety

- Locking system available on every sash.
- High focus on security in all Master Italy TOPFLEX systems.



BRITAL MIDDLE EAST ALUMINIUM SYSTEMS L.L.C
Al Quoz Ind. Area 1
Dubai UAE
info@brital.ae
edition 2025

